



**WIRE ROPE FITTINGS**

# SHOULDER NUT EYE BOLT

## FORGED STEEL-QUENCHED & TEMPERED

SIZE (in.)	DIMENSIONS IN INCHES									WORKING LOAD LIMIT* lbs.	WEIGHT lbs. EACH
	A	B	C	D	E	F	G	H	J		
1/4 X 2	.25	.50	.88	.19	1.50	2.00	2.94	.50	.47	650	.06
1/4 X 4	.25	.50	.88	.19	2.50	4.00	4.94	.50	.47	650	.08
5/16 X 2 1/4	.31	.62	1.12	.25	1.50	2.25	3.50	.69	.56	1,200	.12
5/16 X 4 1/4	.31	.62	1.12	.25	2.50	4.25	5.50	.69	.56	1,200	.18
3/8 X 2 1/2	.38	.75	1.38	.31	1.50	2.50	3.97	.78	.66	1,550	.19
3/8 X 4 1/2	.38	.75	1.38	.31	2.50	4.50	5.97	.78	.66	1,550	.31
1/2 X 3 1/4	.50	1.00	1.75	.38	1.50	3.25	5.12	1.00	.91	2,600	.37
1/2 X 6	.50	1.00	1.75	.38	3.00	6.00	7.88	1.00	.91	2,600	.56
5/8 X 4	.62	1.25	2.25	.50	2.00	4.00	6.44	1.31	1.12	5,200	.75
5/8 X 6	.62	1.25	2.25	.50	3.00	6.00	8.44	1.31	1.12	5,200	1.00
3/4 X 4 1/2	.75	1.50	2.75	.62	2.00	4.50	7.44	1.56	1.38	7,200	1.25
3/4 X 6	.75	1.50	2.75	.62	3.00	6.00	8.94	1.56	1.38	7,200	1.50
7/8 X 5	.88	1.75	3.25	.75	2.50	5.00	8.47	1.84	1.56	10,600	2.25
1 X 6	1.00	2.00	3.75	.88	3.00	6.00	9.97	2.09	1.81	13,300	3.75
1 X 9	1.00	2.00	3.75	.88	4.00	9.00	12.97	2.09	1.81	13,300	4.29
1 1/4 X 8	1.25	2.50	4.50	1.00	4.00	8.00	12.72	2.47	2.28	21,000	6.50
1 1/4 X 12	1.25	2.50	4.50	1.00	4.00	12.00	16.72	2.47	2.28	21,000	7.75
1 1/2 X 15	1.50	3.00	5.50	1.25	6.00	15.00	20.75	3.00	2.75	24,000	14.25

**\*WARNING :** Never exceed working load limit.  
Proof load two times working load limit. Design factor 5 :1 All bolts are hot dip galvanized after threading. Hex nuts are American standard heavy, hot dip galvanized. W.L.L. based on vertical loading.

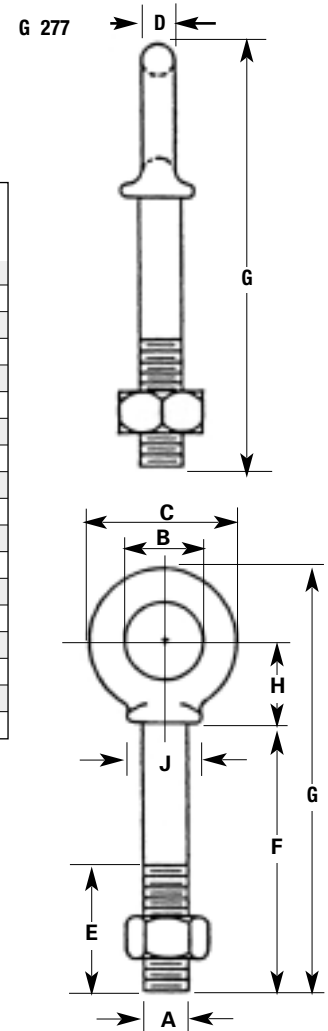

## SHOULDER NUT EYE BOLT APPLICATION

Working load ratings are for in-line pull with respect to centerline of shank.

For angular lifts, the shoulder type eye bolt should be used.

Angular lifts should not be applied to eye bolts that are turned into tapped hole. In making angular lifts the working load should be reduced as follows :

<b>Direction of pull</b>	<b>(adjusted working load)</b>
45°	30% of rated working load
90°	25% of rated working load

The above ratings are for eye bolts having the shoulder firmly seated against the mating part and when the direction of pull is in respect to the plane of the eye as shown in the illustration.

