



WEDGE SOCKETS

OPEN WEDGE SOCKETS

CAST STEEL

WIRE ROPE Dia. in.	DIMENSIONS IN INCHES															WEIGHT* lbs. EACH	
A	B	C	D	F	G	H	J	K	L	P	R	S	T	U	V		
3/8	5.63	2.56	.81	.81	.56	1.13	2.06	2.25	1.06	2.50	1.56	.44	2.06	.44	1.25	1.38	2.00
1/2	6.81	3.44	1.00	1.00	.69	1.38	2.81	3.00	1.31	2.75	1.94	.50	2.44	.53	1.75	1.88	4.75
5/8	8.16	4.06	1.25	1.19	.88	1.75	3.31	3.69	1.50	3.25	2.25	.56	3.13	.69	2.00	2.19	7.75
3/4	9.78	4.81	1.50	1.38	1.00	2.06	3.94	4.38	1.75	4.00	2.63	.66	3.63	.78	2.34	2.56	11.75
7/8	11.16	5.50	1.75	1.63	1.13	2.31	4.50	5.00	2.00	4.50	3.13	.75	4.19	.88	2.69	2.94	20.50
1	12.75	6.13	2.00	2.00	1.31	2.56	5.00	5.75	2.25	5.00	3.75	.88	4.63	1.03	2.88	3.28	30.25
1 1/8	14.38	6.75	2.25	2.25	1.50	2.94	5.50	6.50	2.50	5.63	4.25	1.00	5.38	1.19	3.13	3.56	43.50
1 1/4	16.00	7.38	2.50	2.50	1.63	3.19	6.00	7.25	2.75	6.25	4.75	1.13	5.81	1.31	3.38	3.81	57.20

For intermediate wire rope sizes use next larger size socket.

*Weight of socket, wedge and pin.

Wedge socket terminations have an efficiency rating of 80%, based on the catalog strength of EIPS grade wire rope.

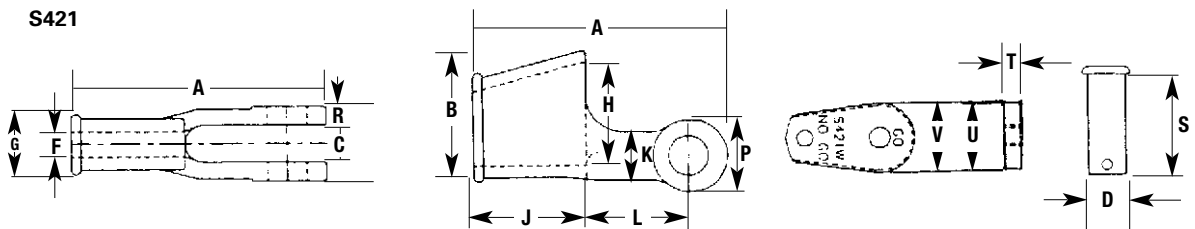

EYE NUTS

FORGED STEEL - QUENCHED & TEMPERED

STANDARD SIZE no.	TAP M	DIMENSIONS IN INCHES								MAXIMUM TAP SIZE	W.L.L.* lbs.	WEIGHT lbs. EACH
		A	C	D	E	F	J	S	T			
1	1/4	1.25	.75	1.06	.66	.50	.69	.25	1.69	3/8	520	.09
1A	5/16	1.25	.75	1.06	.66	.50	.69	.25	1.69	3/8	850	.09
2	3/8	1.63	1.00	1.25	.75	.56	.81	.31	2.06	7/16	1.250	.18
3	7/16	2.00	1.25	1.50	1.00	.81	1.00	.38	2.50	1/2	1.700	.25
3A	1/2	2.00	1.25	1.50	1.00	.81	1.00	.38	2.50	1/2	2.250	.28
4	5/8	2.50	1.50	2.00	1.19	1.00	1.31	.50	3.19	3/4	3.600	.58
5	3/4	3.00	1.75	2.38	1.38	1.13	1.50	.63	3.88	7/8	5.200	1.00
6	7/8	3.50	2.00	2.63	1.63	1.31	1.88	.75	4.31	1	7.200	1.70
7	1	4.00	2.25	3.06	1.88	1.56	2.13	.88	5.00	1 1/4	10.000	2.75
7A	1 1/8	4.00	2.25	3.06	1.88	1.56	2.13	.88	5.00	1 1/4	12.300	2.75
8	1 1/4	4.50	2.50	3.50	1.94	1.88	2.38	1.00	5.75	1 1/2	15.500	3.85
9	1 3/8	5.00	2.75	3.75	2.00	2.00	2.56	1.13	6.25	1 1/2	18.500	5.00
10	1 1/2	5.63	3.13	4.00	2.38	2.25	3.00	1.25	6.75	1 3/4	22.500	6.70
11	2	7.00	4.00	6.25	4.00	3.38	4.00	1.50	10.00	2 3/4	40.000	18.70
11A	2 1/2	7.00	4.00	6.25	4.00	3.38	4.00	1.50	10.00	2 3/4	45.200	18.70

*WARNING: Never exceed working load limit.
Design factor 5 : 1. Ratings based on standard Tap size.

